

LA 10 ZONING

HWY 112

LA 10

C2

LW

M1

Pit Stop

Corner Store

M1

Dollar Store

A

LA 10

C1

Family Clinic

A

LA 3206

A

LA 3206

A

A

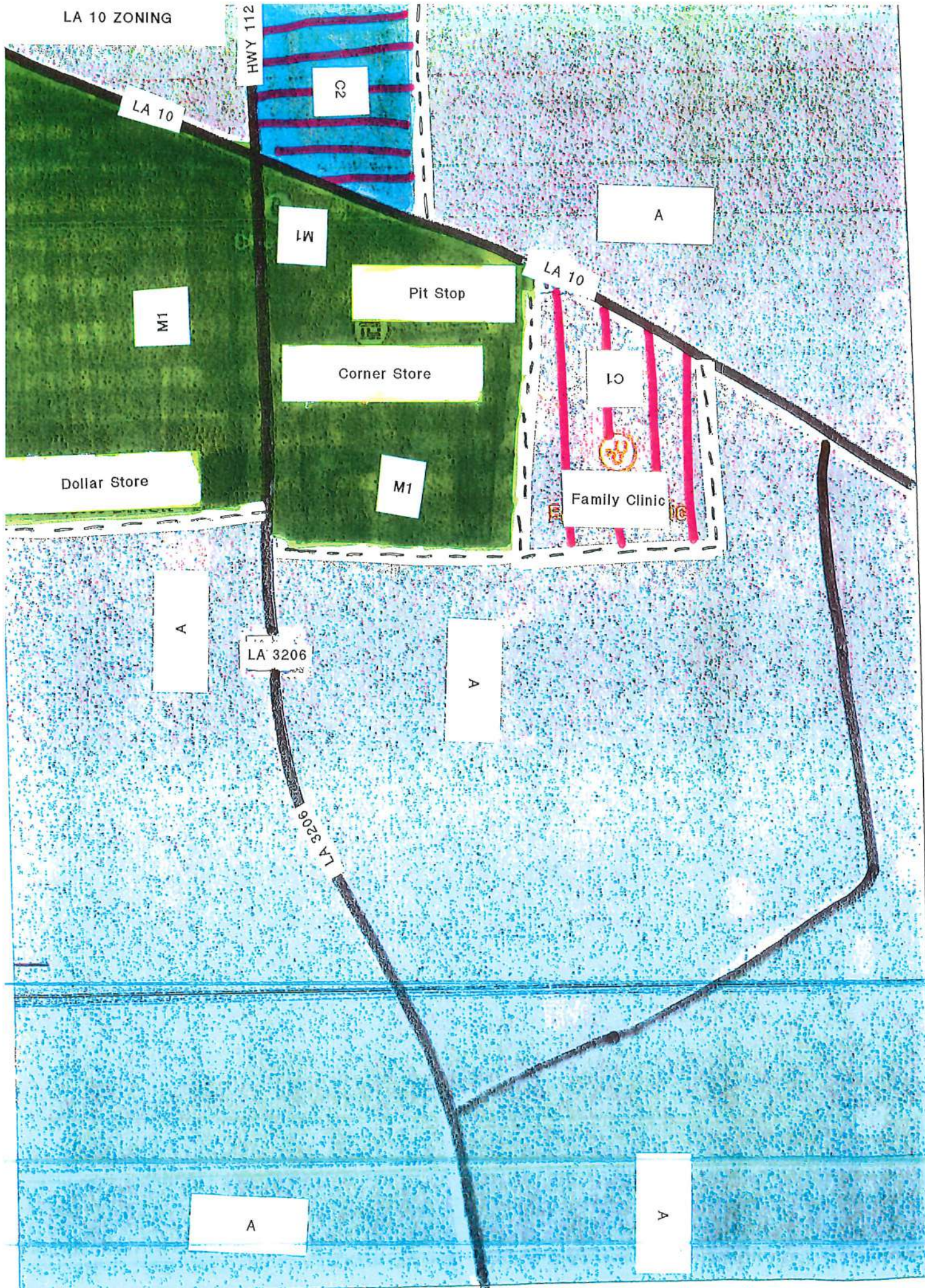



EASTERN HEIGHTS

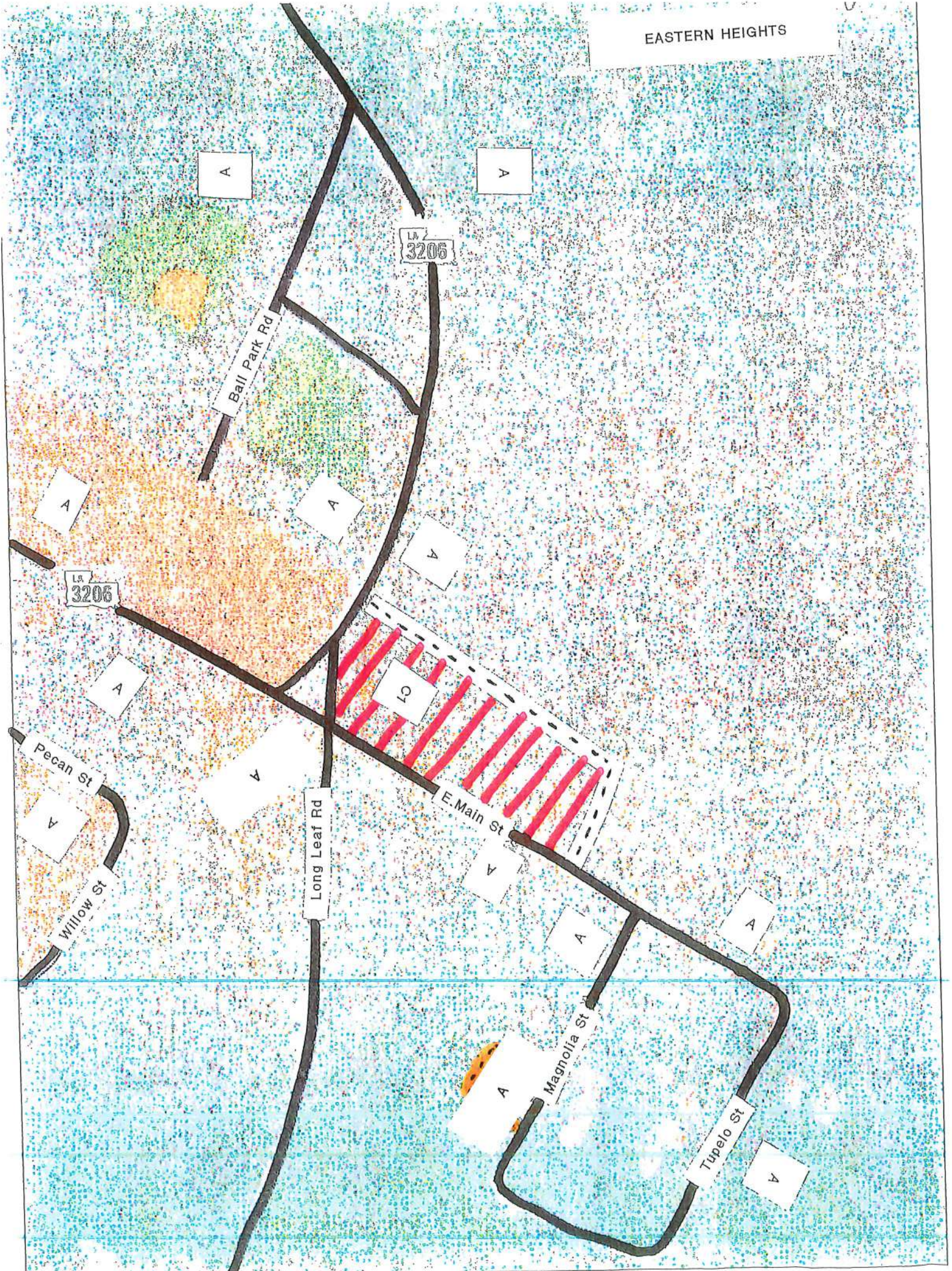

LA 3206

A

A

Ball Park Rd

A

A

LA 3206

A

G1

Pecan St

A

Long Leaf Rd

E. Main St

A

Willow St

A

A

Magnolia St

A

Tupelo St

A



IN TOWN ZONING



LA 1156

LA 3206

LA 1156

LA 1156

Elizabeth High School

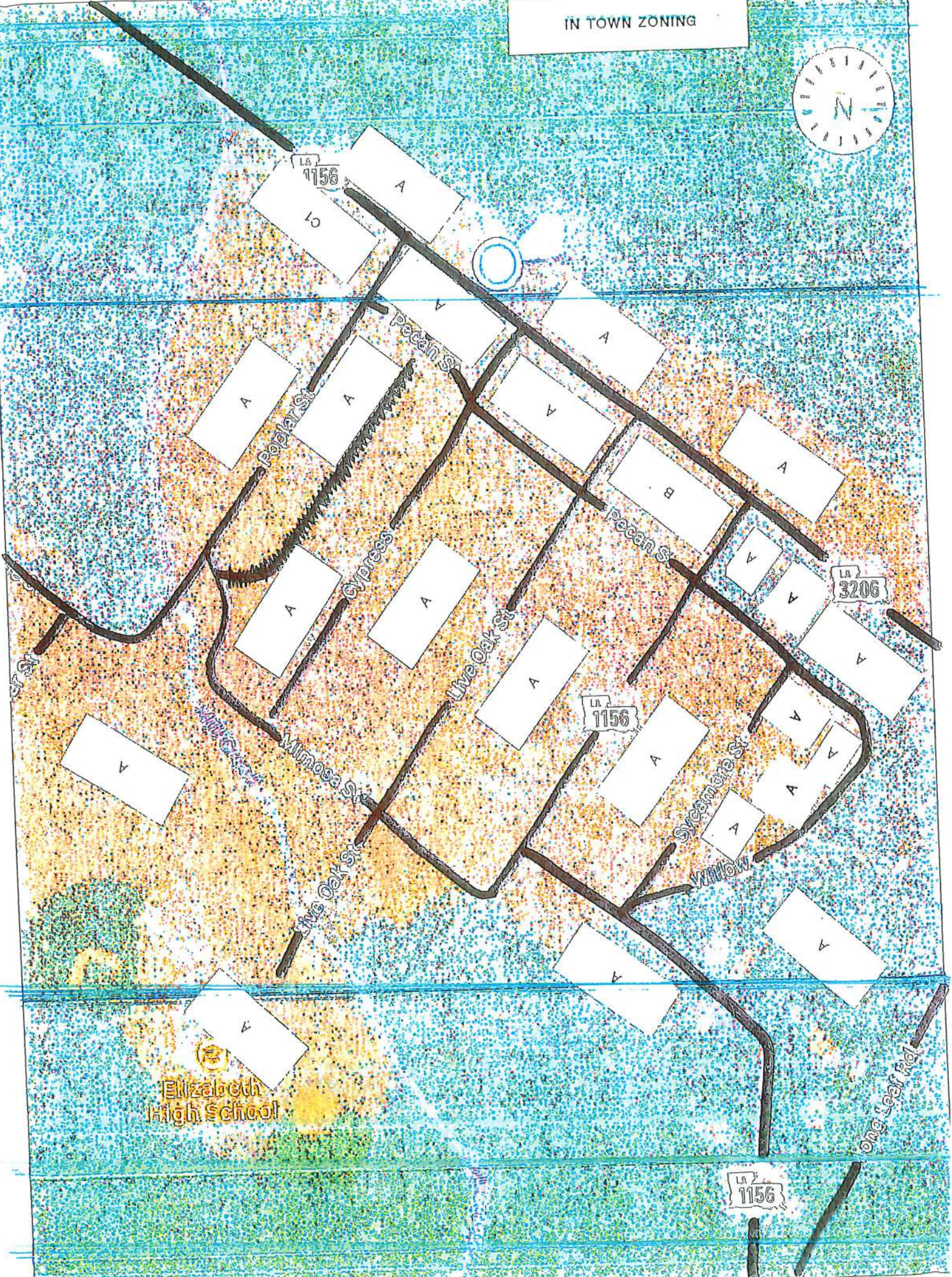



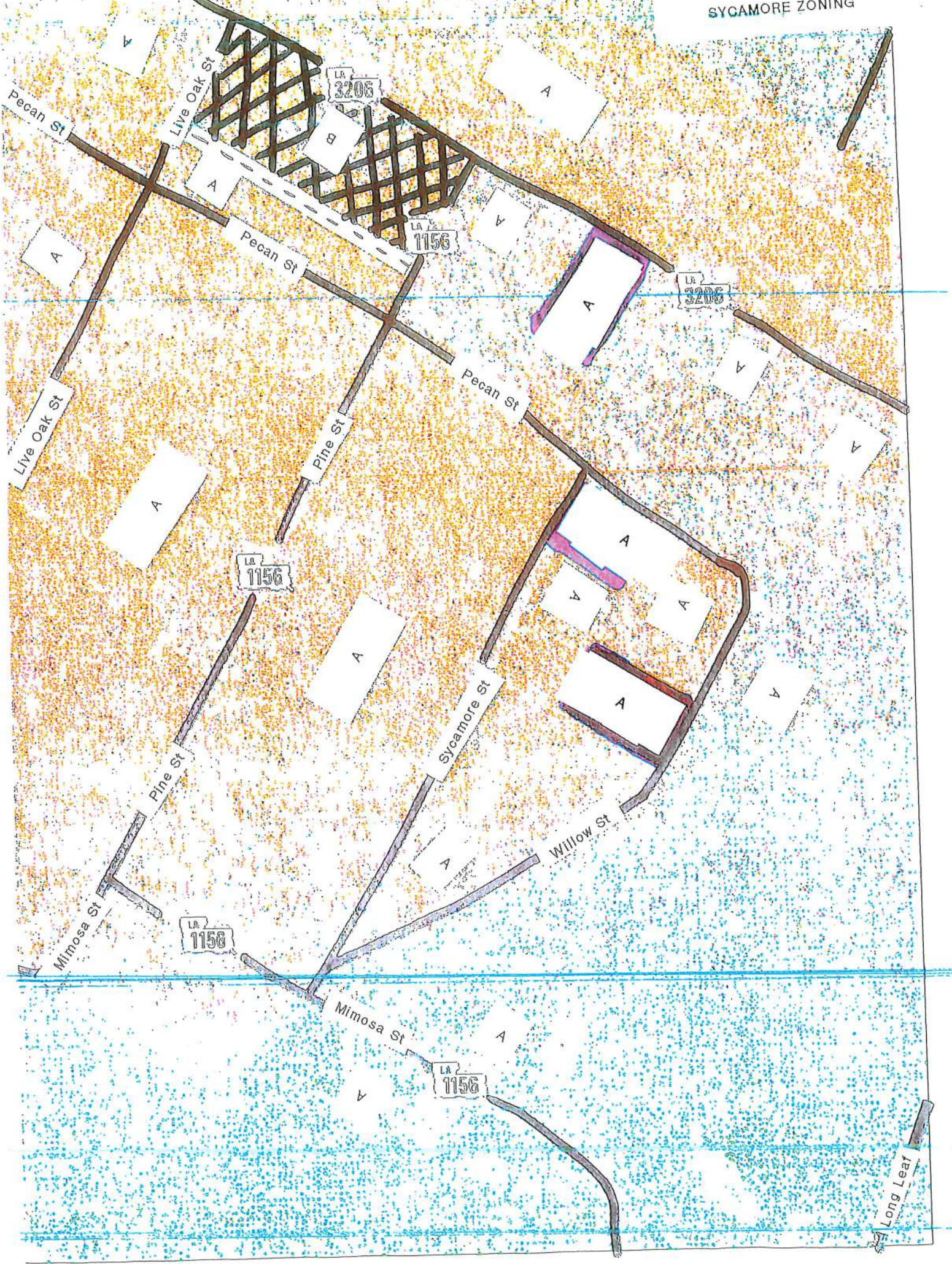



CLINIC / CITY HALL

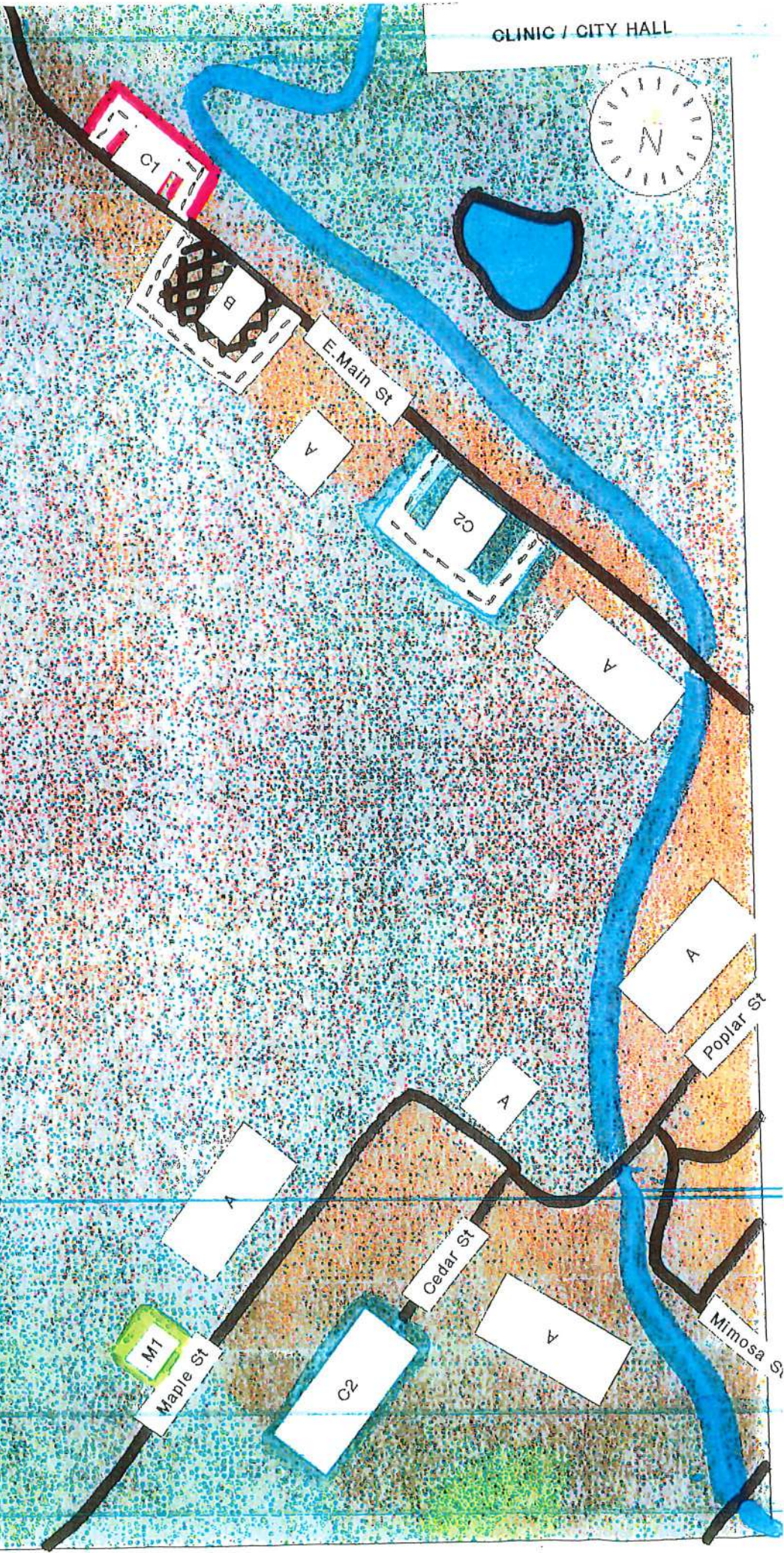
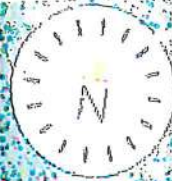

Dogwood St

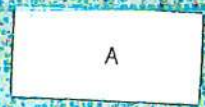

Maple St



Cedar St



Poplar St

Mimosa St

E. Main St

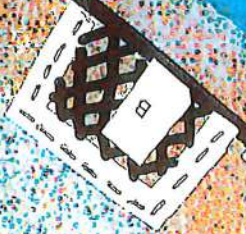



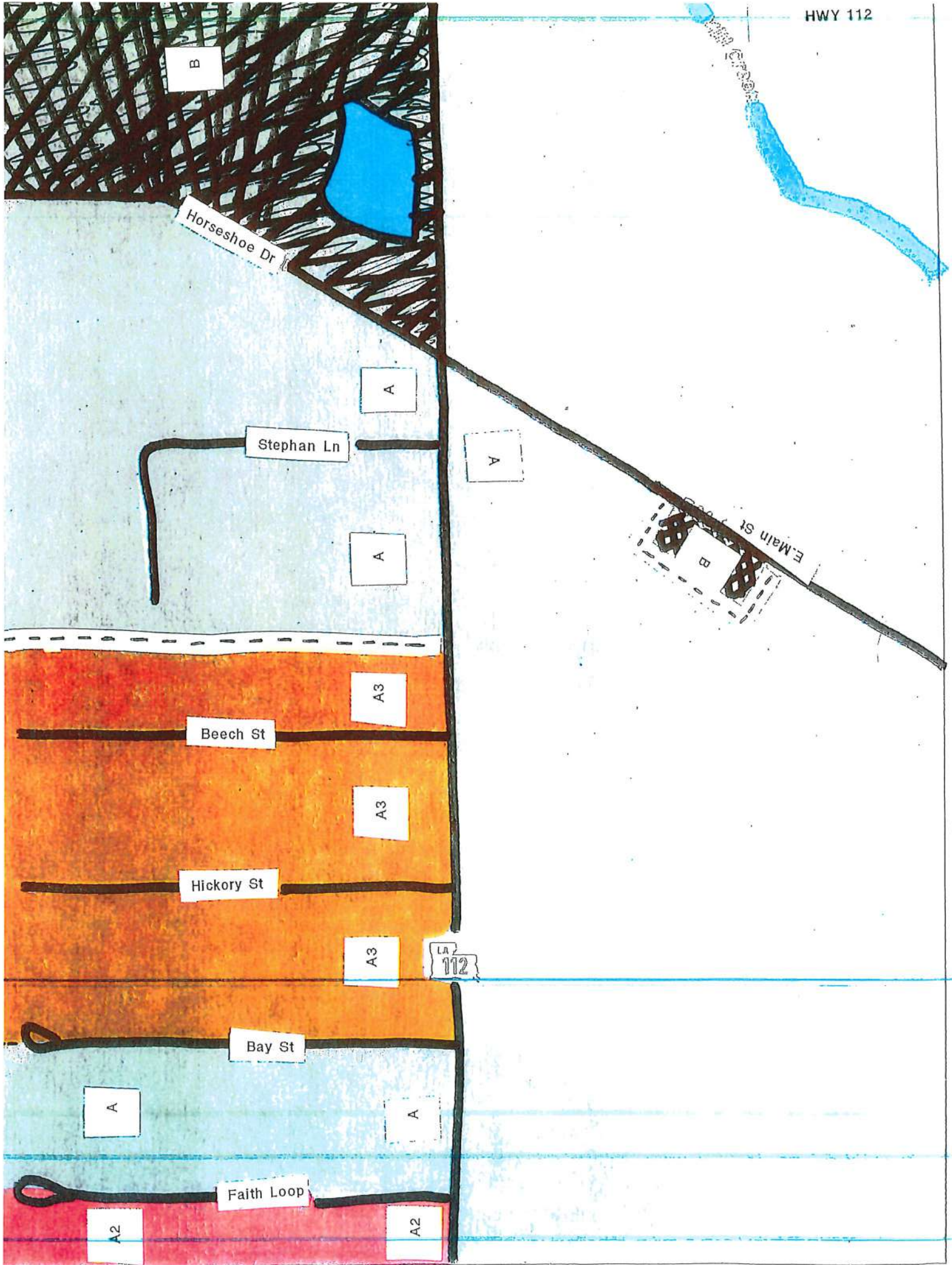

B

Horseshoe Dr

A

Stephan Ln

A

A

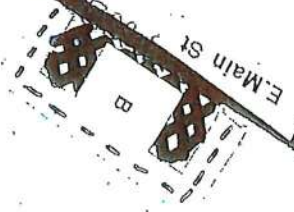

E. Main St

A3

Beech St

A3

Hickory St

A3

LA 112

Bay St

A

A

Faith Loop

A2

A2



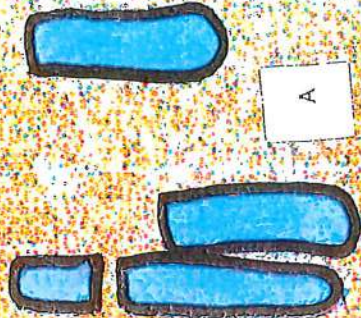

A

HWY 112

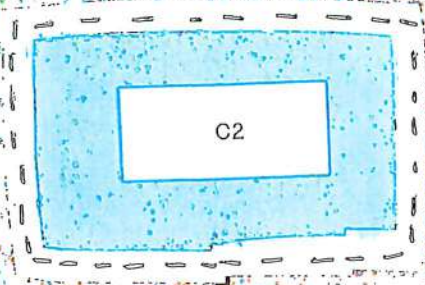

C2

A

A

A

Dogwood St

A

Horseshoe Dr

Maple St



C1

A



M1

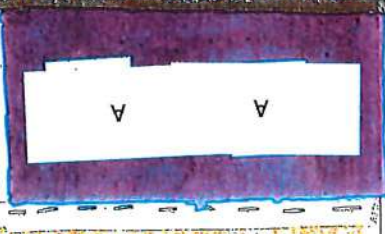

A

A

A



A

LA 112

